

THE HARI

LONDON
BELGRAVIA

Events, meetings and private dining



The Muse

32.25m², 347ft²

The Muse is a private meeting room with an integrated screen and projector by day and an exclusive dining room by night. Floor-to-ceiling windows, a solid oak table, fireplace and luxurious furnishings creates the perfect setting of a warm and versatile sit-down space ideal for engaging minds and stomachs.

CAPACITY

Full Room	up to 24 pax
Half Room with plasma screen	up to 10 pax
Half Room with projector	up to 6 pax



The Snug

35.5m², 382ft²

The Snug, located on the first floor is complete with cashmere sofas, sumptuous lighting, its very own fireplace and a plasma screen. This semi private space is perfect for intimate gatherings and celebrations.

Whatever happens at The Snug stays in The Snug...

CAPACITY

Seating	up to 20 pax
Standing	up to 60 pax

The Bar

106.75m², 1149ft²

The Bar's velvet booths, atmospheric lighting and an eclectic cocktail list sets the tone for a party. An intimate yet glamorous space decked out in vintage Danish furniture and adorned with artwork by British artists. The Bar is the perfect venue to host private celebrations, launch new products or facilitate corporate networking, for up to 180 people.

CAPACITY

Standing up to 180 pax
(Includes use of terrace until 11pm)



The Garden Terrace

29.25m², 315ft²

The Garden Terrace is an urban oasis with living walls, a retractable roof and heaters. The perfect space for entertaining under the stars...

Try something different for your next event with one of our fun concepts including barbecues with your very own chef or our whisky and cigar tastings with a dedicated cigar sommelier.

CAPACITY

Standing up to 30 pax
Seated up to 15 pax



Floor Plan

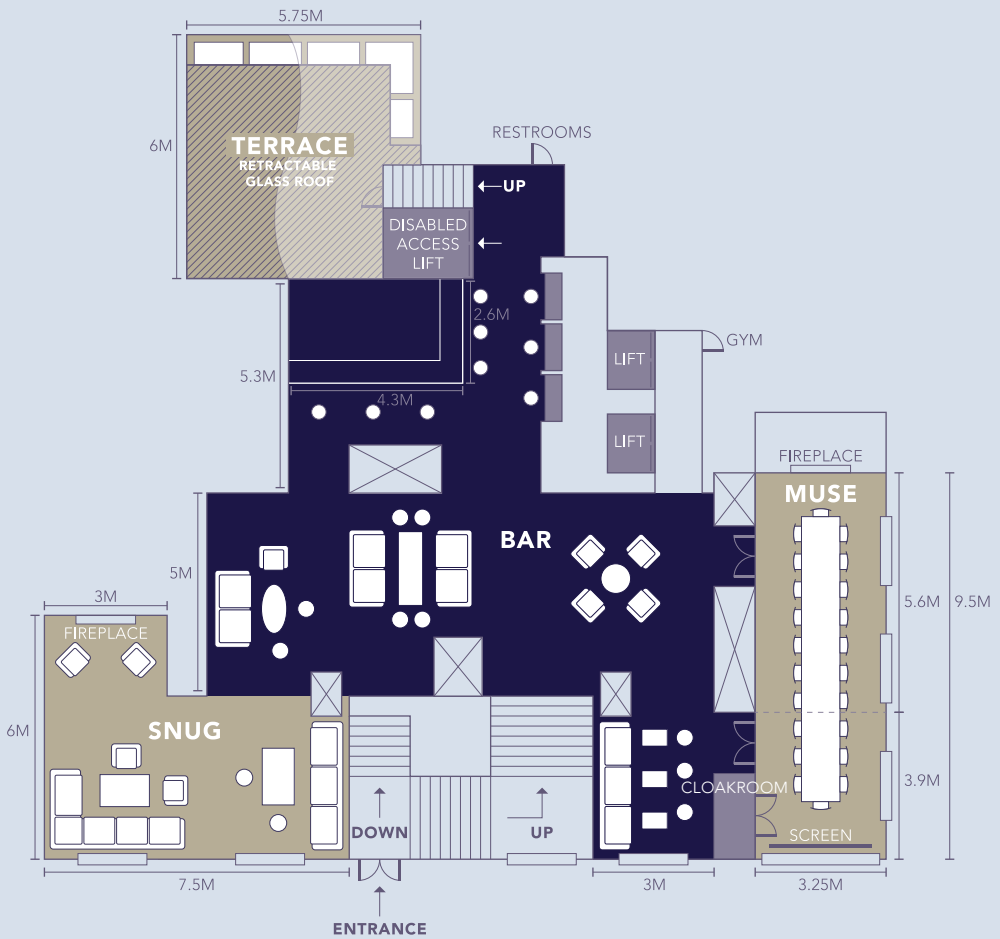

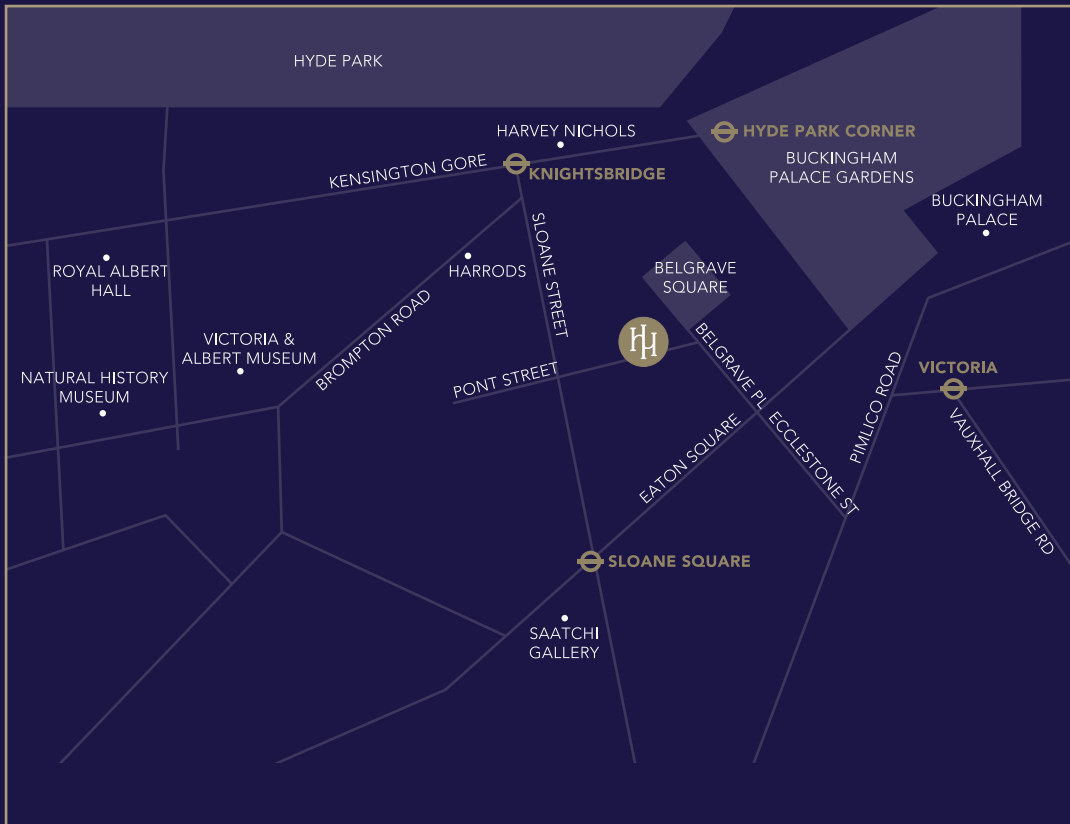

20 Chesham Place, London SW1 8HQ

t+44 (0)20.7858.0100 | events@thehari.com | www.thehari.com

LIFESTYLE[®]
Preferred
HOTELS & RESORTS



  
#THEHARI